

BR-TB26-00EN

T I F E

S E R I E S Clean Steam Filter



FLOWMAX

TUF SERIES

Clean Steam Filter

DIAMETER	1/2" - 2" DN15 - DN150
CONNECTION TYPES	Flanged (EN1092) Threaded BSP Weld End
BODY MATERIAL	AISI 304L, AISI 316L
MAX. ALLOWABLE PRESSURE	8,5 bar g
MAX. OPERATING TEMPERATURE	178 °C

High Efficiency Filtration Solution for Clean Steam Applications

Filter Options

- » 1µm
- » 5µm
- » 25µm

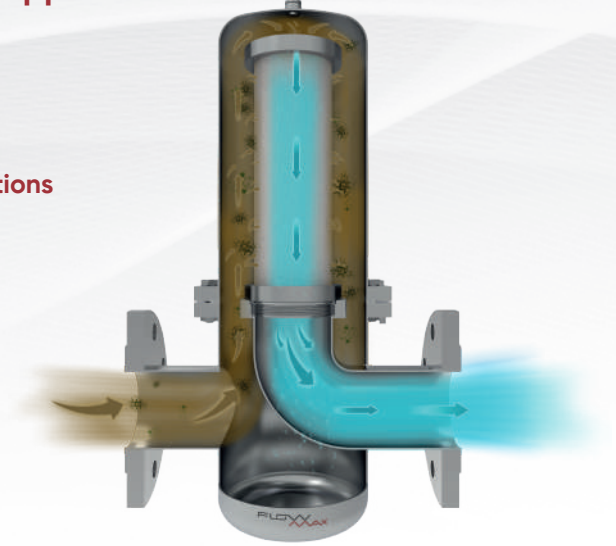

Coding

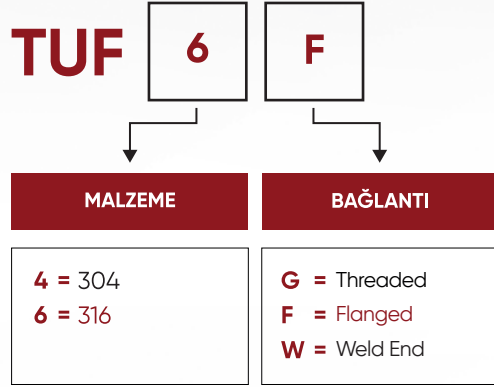

Clean Steam, Maximum Filtration

Flowmaxi clean steam filters provide clean steam in all applications you need by effectively capturing particles in the process steam.

Dimensions

Product Size	A mm	B mm	ØC mm	ØD mm	Correction Factor
03/10	76	12	3/4"	42	0,12
04/10	104	12	3/4"	42	0,17
04/20	104	14	1"	52	0,19
05/20	104	14	1"	52	0,19
05/25	128	14	1"	32	0,32
05/30	128	16	2"	86	0,46
07/25	180	14	1"	62	0,47
07/30	180	16	2"	86	0,68
10/30	254	16	2"	86	1,00
15/30	381	16	2"	86	1,55
20/30	508	16	2"	86	2,10
30/30	762	16	2"	86	3,28
30/50	762	16	3"	140	5,89

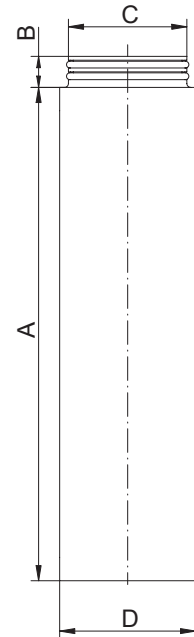

Industrial



Pharmaceutical



Healthcare



Food and Beverage



Other Industries



Maximum Reliability in Flow Control!

Fevzi akmak Mah. 10576. Sk. NO:13/M Karatay/**KONYA/TÜRKİYE**

info@flowmaxi.com

+90 (850) 255 06 67



www.flowmaxi.com.tr